

PRIZEMLJE m 1:100

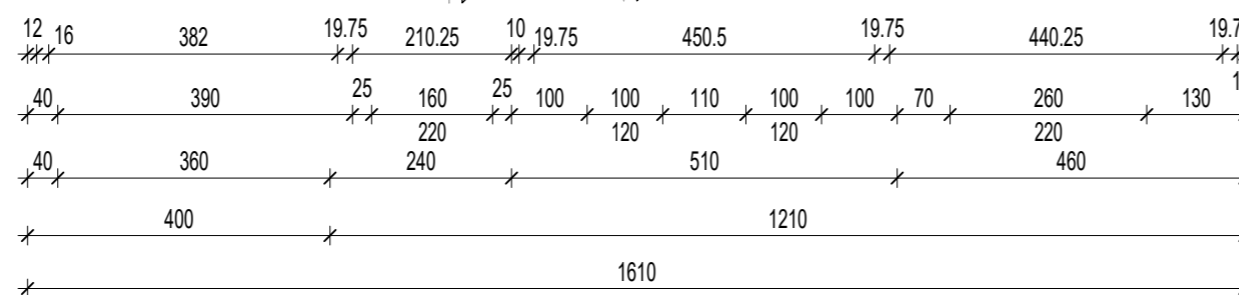
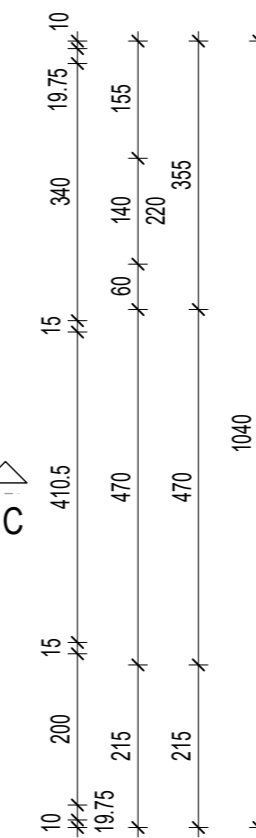
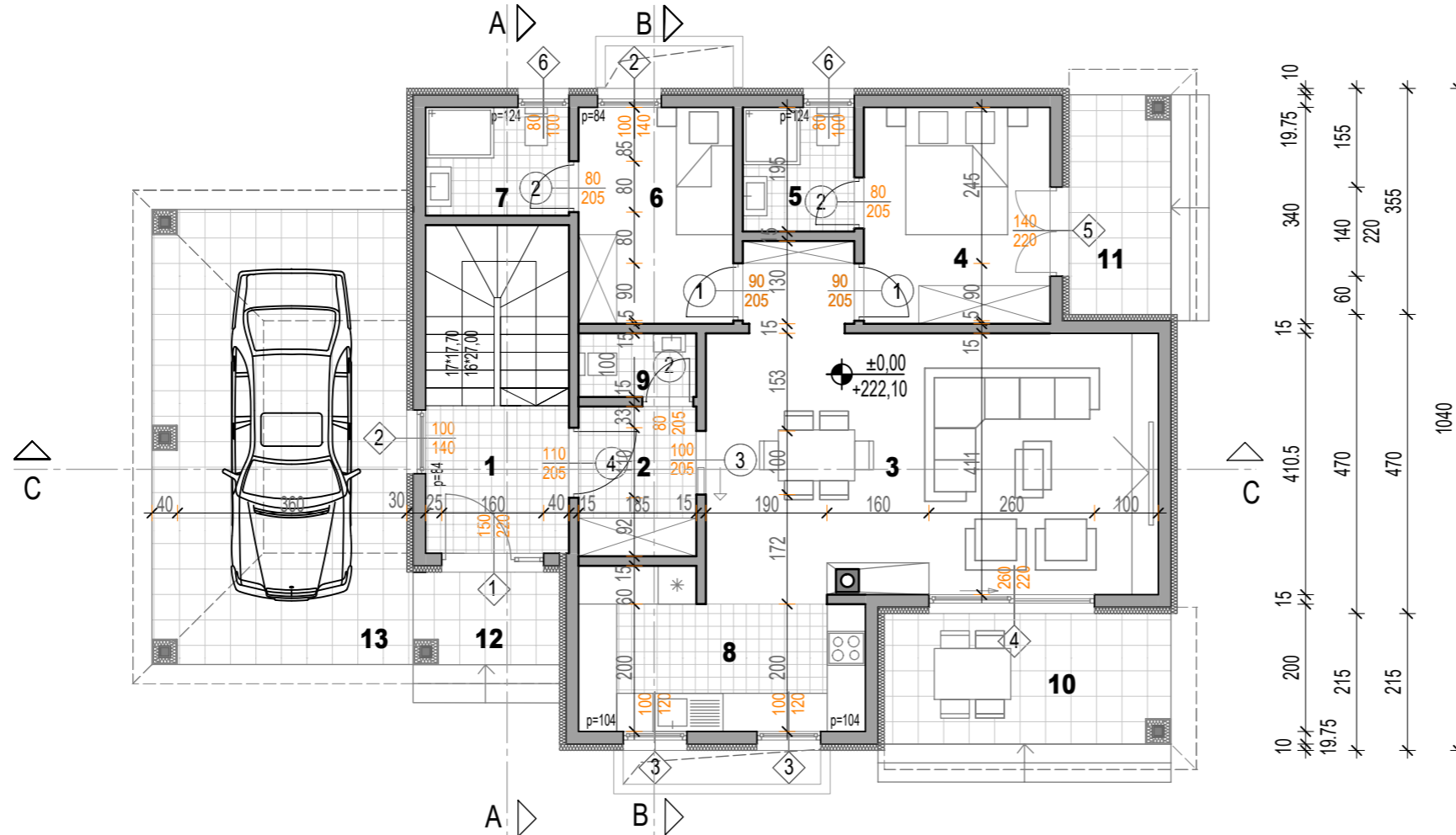
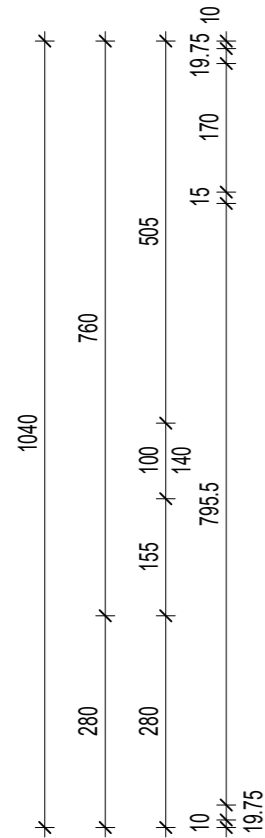
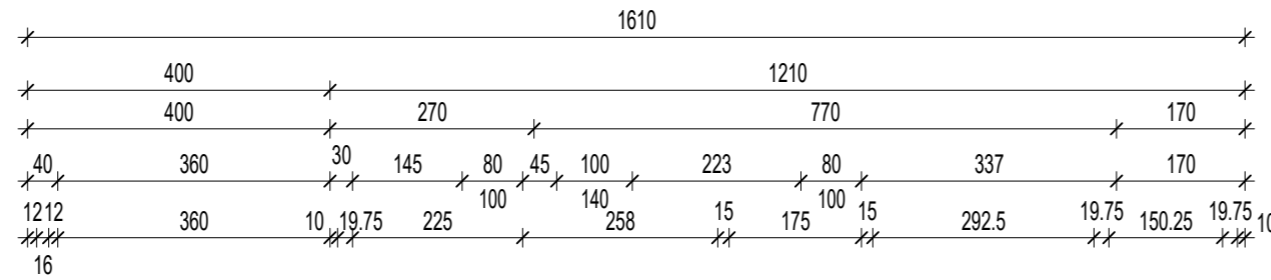
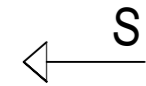

- | | |
|---|--|
| 1. STUBIŠTE
P = 11,60 m ²
O = 14,80 m ¹
keramičke pločice | 7. KUPAONICA
P = 3,81 m ²
O = 7,90 m ¹
keramičke pločice |
| 2. ULAZNI PROSTOR
P = 4,35 m ²
O = 8,40 m ¹
keramičke pločice | 8. KUHINJA
P = 10,13 m ² * 0,50 = 10,73 m ²
O = 14,20 m ¹
keramičke pločice |
| 3. DNEVNI BORAVAK
BLAGOVAONICA
P = 31,80 m ²
O = 27,00 m ¹
parket | 9. WC
P = 1,85 m ²
O = 5,70 m ¹
keramičke pločice |
| 4. SPAVAĆA SOBA
P = 9,94 m ²
O = 12,60 m ¹
parket | 10. NATKRIVENA TERASA
P = 9,23 m ² * 0,50 = 4,62 m ²
O = 13,10 m ¹
keramičke pločice |
| 5. KUPAONICA
P = 3,41 m ²
O = 7,40 m ¹
keramičke pločice | 11. NATKRIVENA TERASA
P = 5,52 m ² * 0,50 = 2,76 m ²
O = 10,10 m ¹
keramičke pločice |
| 6. SPAVAĆA SOBA
P = 8,26 m ²
O = 11,70 m ¹
parket | 12. NATKRIVENI ULAZ
P = 3,34 m ² * 0,50 = 1,75 m ²
O = 7,50 m ¹
keramičke pločice |
| | 13. NATKRIVENO PARKIRALIŠTE
P = 28,63 m ² * 0,50 = 14,32 m ²
O = 22,50 m ¹
keramičke pločice |

NETO POVRŠINE:

unutarnji prostor - zatvoreni	85,15 m ²
vanjski prostor - otvoreni	23,36 m ²
bazen	24,16 m ²
UKUPNO bez bazena	138,75 m²

NAPOMENA:

- navedena oznaka vanjske i unutarnje stolarije predstavlja građevinsku mjeru stolarije
- visina parapeta je navedena od kote gotovog poda etaže do gornje kote unutarnje prozorske klupčice

LEGENDA:

- ① $\frac{90}{205}$ drvena stolarija - unutarnja
- ① $\frac{80}{220}$ PVC stolarija - vanjska